

NORTH PARK DRIVE OFFICE WAREHOUSE

7123 NORTH PARK DR
RICHMOND TEXAS 77407



CALL BEFORE YOU DIG!!
TEXAS ONE CALL PARTICIPANTS REQUEST
48 HOURS NOTICE
BEFORE YOU DIG, DRILL, OR BLAST – STOP, CALL:
Texas One Call System
1 (800) 545 – 6005
Houston: (713) 223 – 4567

FBC 48 HOURS NOTICE :

Contractor shall notify Fort Bend County Engineering Department 48 hours prior to commencing construction and 48 hour notice to any construction activity within the limits of the paving at Construction@fortbendcountytx.gov .

Construction Plans for:

PROPOSED OFFICE WAREHOUSE

Developer/Owner:

KATY DOJO LLC

Project Engineer:

HOU ★ TEX ENGINEERING, LLC.

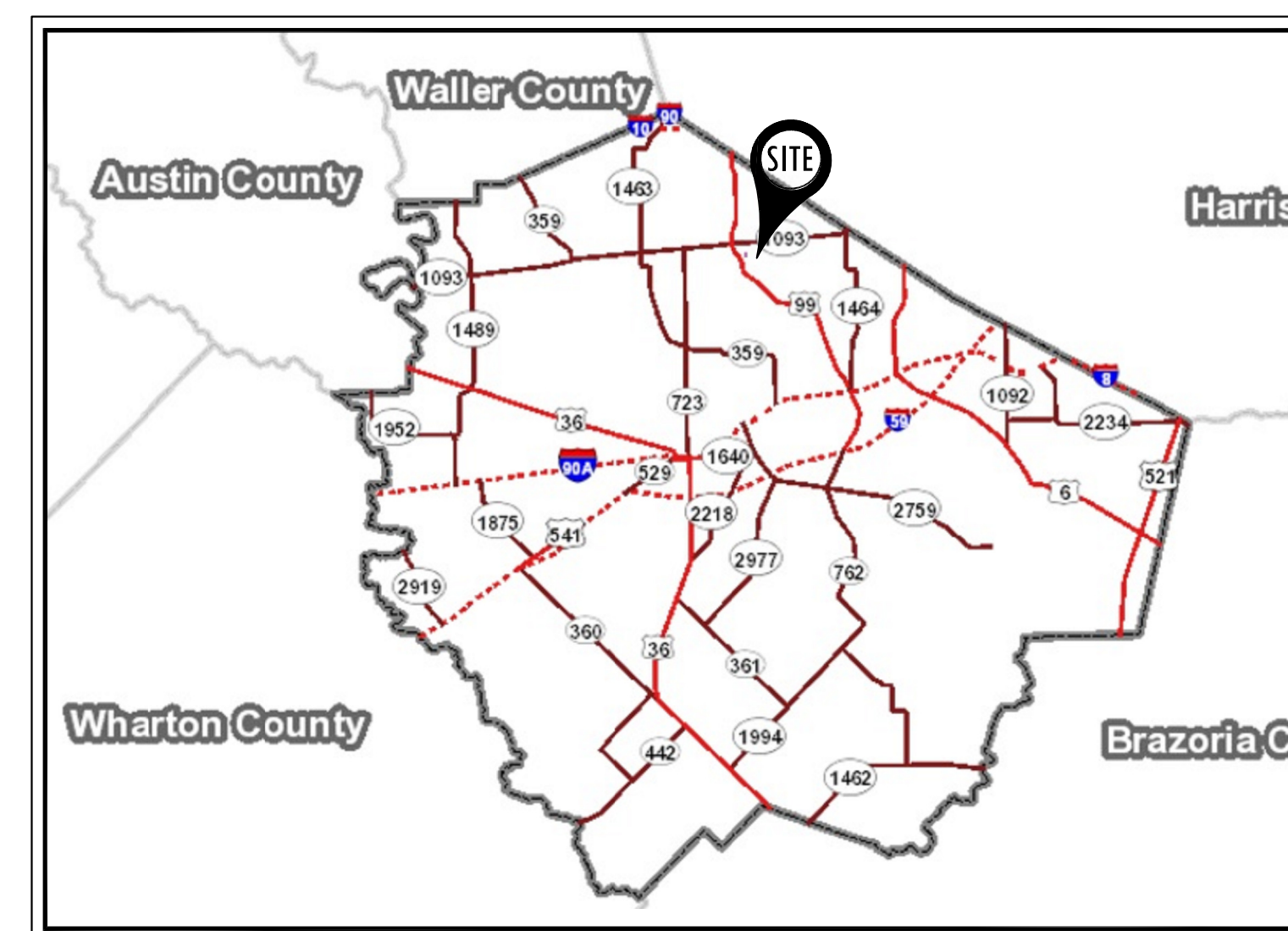

LOCATION MAP
KEY MAP# 407-U N.T.S.

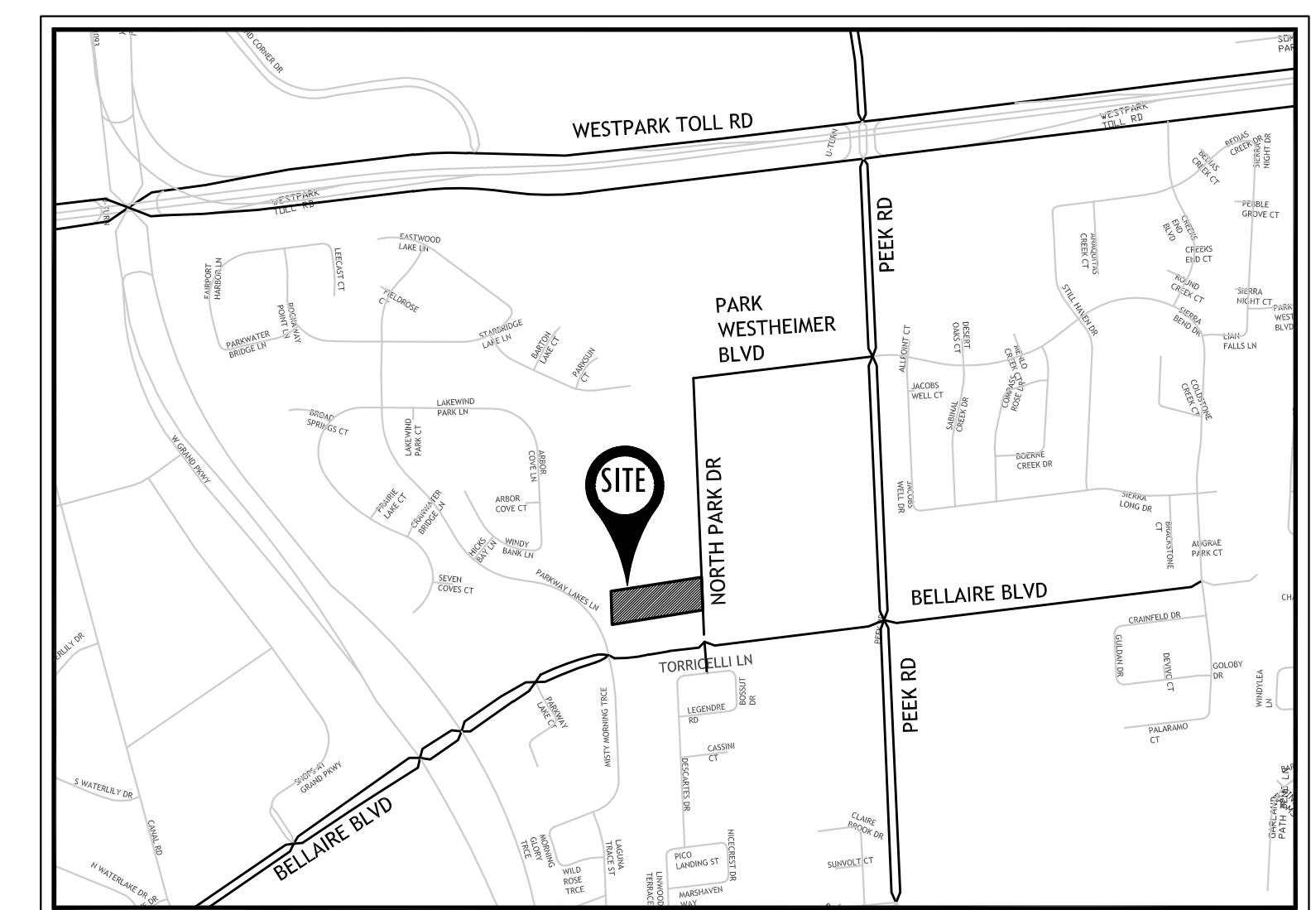

VICINITY MAP
KEY MAP# 407-U N.T.S.

PROPERTY LEGAL DESCRIPTION
1.2216 ACRES LOT 9, IN TRACT NO. 6 SITUATED IN THE THE WILLIAM STANLEY SURVEY ABSTRACT NO. 599 FORT BEND COUNTY, TEXAS

BENCHMARK DATA
ELEVATIONS ARE BASED IN HARRIS COUNTY FLOODPLAIN REFERENCE MARKER NO. 190030 ELEVATION=106.06 FEET NAVD88 2001 ADJ.

FLOOD PLAIN DATA
THIS PROPERTY DOES NOT LIE WITHIN THE 100 YEAR FLOOD PLAN AS PER FIRM PANEL NO. 48157C 0110 L MAP REVISION: 04/02/2014 ZONE X BASED ONLY ON VISUAL EXAMINATION OF MAPS. INACCURACIES OF FEMA MAPS PREVENT EXACT DETERMINATION WITHOUT DETAILED FIELD STUDY.

SURVEYOR
EDILBERTO V. BARRIENTOS PROFESSIONAL LAND SURVEYOR
NO. 5364 JOB NO. 16-05080 JUNE 10, 2016

9111 Katy Freeway, Suite 226
Houston, Texas 77024
E-mail: Info@HouTexEngineering.com
Phone: (713) 973-1400 Fax: (281) 888-9001
Civil Engineering and consultant

FIRM NAME: HOUTEX ENGINEERING
FIRM REGISTRATION NUMBER: F-12522

SHEET NO.	INDEX
1	COVER SHEET
2	SP.001 SITE PLAN
3	SP.002 SITE PLAN DIMENSION
4	A.001 FIRST FLOOR PLAN AND ELEVATION
5	A.002 SECOND FLOOR PLAN AND ELEVATION
6	A.003 SECTION

COVER SHEET

F.B.C. PROJECT NO: #2018-22186

PROJ # HT1713901
SHEET NO. 1 OF 6